

WTH

$\beta=-19.5283^\circ$
 $\alpha=20^\circ$
 GB/T 10095-2008 5
 e24

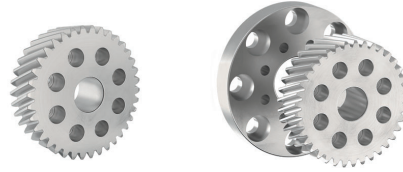

	m mm	z	b mm	da mm	d mm	x mm	D1g6 mm	L1 mm	L2 mm	D2 mm	d*π mm	T2B Nm	F2T N
WTH/WTHR064	2	26	26	61	55.174	0.4	64	45.5	16.5	86	173.334	36	1287
WTH/WTHR090	2	29	26	66.9	61.54	0.3	90	66	24	118	193.334	67	2174
	2	33	26	75.4	70.028	0.3	90	56	24	118	220	82	2348
	2	37	26	83.9	78.517	0.3	90	56	24	118	246.667	91	2317
WTH/WTHR110	2	35	26	79.7	74.272	0.3	110	65	23	145	233.334	140	3770
	2	40	26	90.3	84.883	0.3	110	55	23	145	266.667	170	4000
	2	45	26	100.6	95.493	0.22	110	55	23	145	300	191	4000
WTH/WTHR140	3	31	31	106.7	98.676	0.3	140	82	32	179	310	488	9882
	3	35	31	119.4	111.409	0.3	140	69	32	179	350	603	10817
	3	40	31	135.3	127.324	0.3	140	69	32	179	400	673	10575
WTH/WTHR200	4	38	41	171.4	161.277	0.25	200	91	41.5	247	506.667	1600	19842

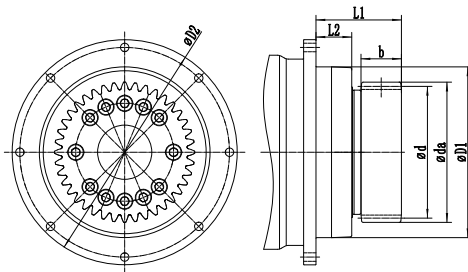

WSH

$\beta=-19.5283^\circ$
 $\alpha=20^\circ$
 GB/T 10095-2008 5
 e25



	m mm	z	b mm	da mm	d mm	x mm	D1g6 mm	L1 mm	L2 mm	D2 mm	d*π mm	T2B Nm	F2T N
WSH/WSHR060	2	15	26	38	31.831	0.5	60	48	18	62	100	35	2183
	2	16	26	40.2	33.953	0.5	60	48	18	62	106.667	36	2122
	2	18	26	44	38.197	0.4	60	48	18	62	120	40	2100
WSH/WSHR075	2	18	26	44	38.197	0.4	70	56	18	76	120	59	3096
	2	20	26	48.3	42.441	0.4	70	56	18	76	133.334	65	3065
	2	22	26	52.5	46.686	0.4	70	56	18	76	146.667	71	3036
WSH/WSHR100	2	23	26	54.6	48.808	0.4	90	64	28	107	153.334	130	5300
	2	25	26	58.8	53.052	0.4	90	64	28	107	166.667	141	5300
	2	27	26	62.7	57.296	0.3	90	64	28	107	180	151	5300
WSH/WSHR140	3	20	31	72.3	63.662	0.4	130	81	27	140	200	303	9500
	3	22	31	78.6	70.028	0.4	130	81	27	140	220	333	9500
	3	24	31	85	76.394	0.4	130	81	27	140	240	363	9500
WSH/WSHR180	4	20	41	96.3	84.883	0.4	160	84	27	182	266.667	573	13500
WSH/WSHR210	4	25	41	117	106.103	0.34	180	103	35	212	333.334	902	17000

